

Mill Lake

Plat of Survey

of

Lot 6 of Baywood Estates Subdivision, located in the Northwest 1/4 of Section 1, Town 3 North, Range 16 East, Town of Sugar Creek, Walworth County, Wisconsin,

Also part of Lot 5 of said Baywood Estates Subdivision as described below:

A parcel of land being part of Lot 5 of Baywood Estates Subdivision, located in the Northwest 1/4 of Section 1, Town 3 North, Range 16 East, Town of Sugar Creek, Walworth County, Wisconsin, described as follows: Commence at an iron pipe marking the Southwest Corner of said Lot 5; thence N 26°41'20" W, along the West line of said Lot 5, 238.66 feet to a found iron pipe on the meander line of Lauderdale Lake and the Point of Beginning; thence continue N 26°41'20" W, along said West line of Lot 5, ±79.5 feet to the shore of said Lauderdale Lake; thence northeasterly along said shore line ±2.8 feet; thence S 24°39'00" E ±79.5 feet to the Point of Beginning. Said parcel contains 0.003 acres (112 sq.ft.) of land, more or less.

Excepting from said Lot 6 a parcel of land as described below:

A parcel of land being part of Lot 6 of Baywood Estates Subdivision, located in the Northwest 1/4 of Section 1, Town 3 North, Range 16 East, Town of Sugar Creek, Walworth County, Wisconsin, described as follows: Begin at a found iron pipe marking the Southeast Corner of said Lot 6; thence S 62°46'16" W, along the South line of said Lot 6, 8.50 feet; thence N 24°39'00" W 238.89 feet to a found iron pipe on the East line of said Lot 6 and the meander line of Lauderdale Lake; thence S 26°41'20" E, along said East line, 131.16 feet; thence S 63°18'40" W 4.67 feet; thence S 34°44'37" E 33.33 feet to said East line of Lot 6; thence S 26°41'20" E, along said East line, 74.50 feet to the Point of Beginning. Said parcel contains 0.022 acres (937 sq.ft.) of land, more or less.

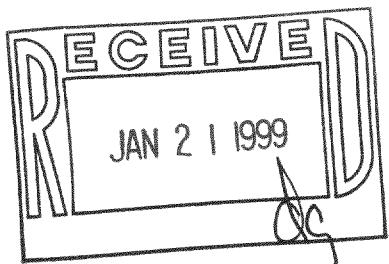
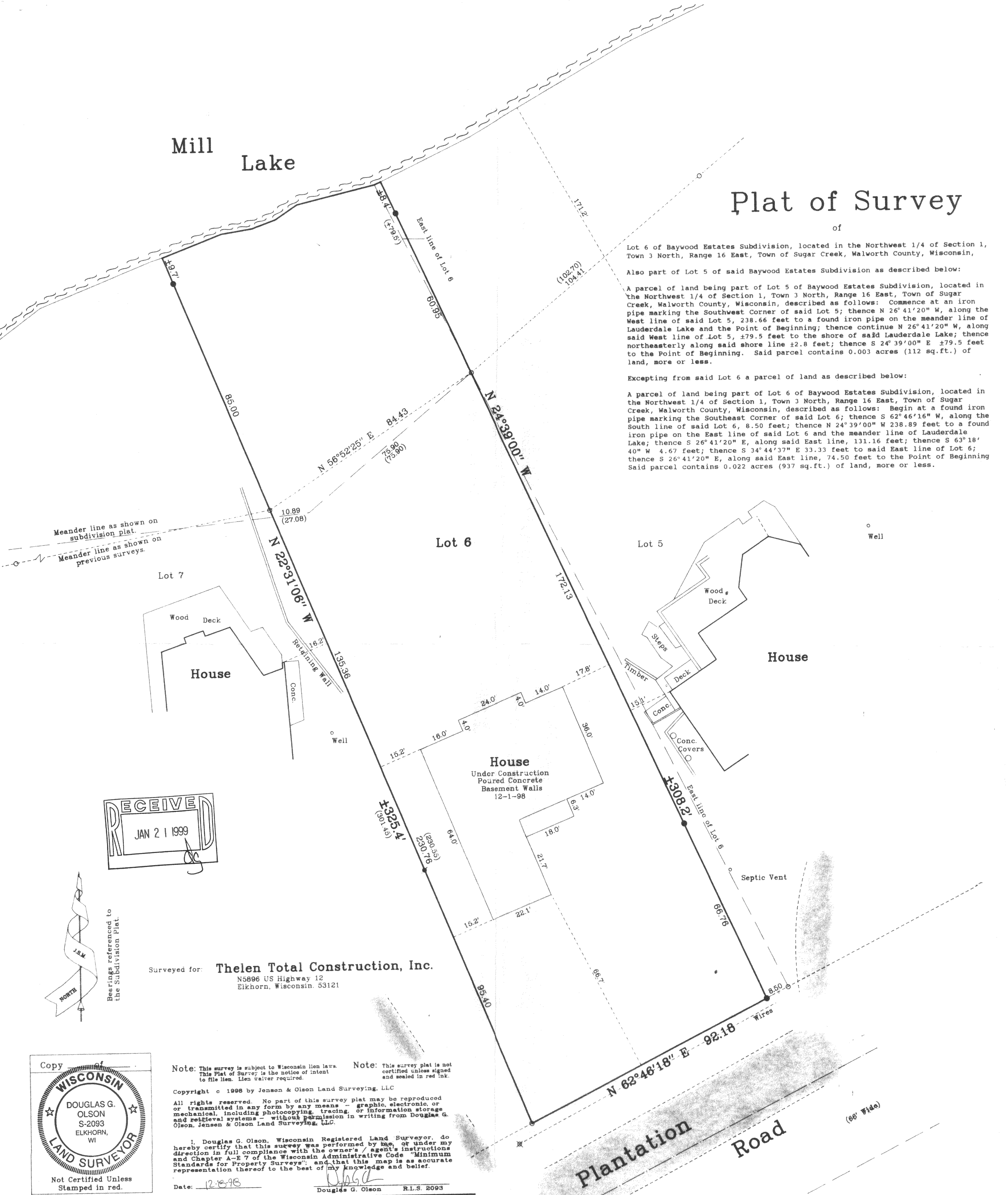

Surveyed for: **Thelen Total Construction, Inc.**
N5896 US Highway 12
Elkhorn, Wisconsin. 53121

Note: This survey is subject to Wisconsin lien laws. This Plat of Survey is the notice of intent to file lien. Lien waiver required.

Note: This survey plat is not certified unless signed and sealed in red ink.

Copyright © 1998 by Jensen & Olson Land Surveying, LLC

All rights reserved. No part of this survey plat may be reproduced or transmitted in any form by any means - graphic, electronic, or mechanical, including photocopying, tracing, or information storage and retrieval systems - without permission in writing from Douglas G. Olson, Jensen & Olson Land Surveying, LLC.

I, Douglas G. Olson, Wisconsin Registered Land Surveyor, do hereby certify that this survey was performed by me, or under my direction in full compliance with the owner's / agent's instructions and Chapter A-E 7 of the Wisconsin Administrative Code "Minimum Standards for Property Surveys"; and that this map is as accurate representation thereof to the best of my knowledge and belief.

Date: 12-8-98
Douglas G. Olson R.L.S. 2093

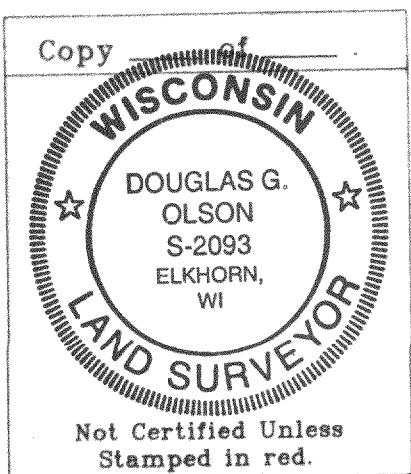

Jensen & Olson Land Surveying, LLC

45 South Wisconsin Street P.O. Box 322
Elkhorn, Wisconsin. 53121
Telephone: (414) 723-3434
Facsimile: (414) 723-8044

Mapping Date: 12-08-98
Revisions:

Sheet 1 of 1 Sheets

Job Reference No.

1998.101

1998.064

Legend

- Found Iron Pipe
- Found Iron Rod
- Set Iron Rod
- () Recorded Information
- ✕ Utility Pole
- Blacktop Surface

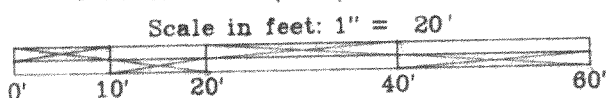

Mill Lake

Lake Elevation
884.82 on 8-20-98.

Plat of Survey

of

Lot 6 of Baywood Estates Subdivision, located in the Northwest 1/4 of Section 1, Town 3 North, Range 16 East, Town of Sugar Creek, Walworth County, Wisconsin,

Also part of Lot 5 of said Baywood Estates Subdivision as described below:

A parcel of land being part of Lot 5 of Baywood Estates Subdivision, located in the Northwest 1/4 of Section 1, Town 3 North, Range 16 East, Town of Sugar Creek, Walworth County, Wisconsin, described as follows: Commence at an iron pipe marking the Southwest Corner of said Lot 5; thence N 26°41'20" W, along the West line of said Lot 5, 238.66 feet to a found iron pipe on the meander line of Lauderdale Lake and the Point of Beginning; thence continue N 26°41'20" W, along said West line of Lot 5, ±79.5 feet to the shore of said Lauderdale Lake; thence northeasterly along said shore line ±2.8 feet; thence S 24°39'00" E ±79.5 feet to the Point of Beginning. Said parcel contains 0.003 acres (112 sq.ft.) of land, more or less.

Excepting from said Lot 6 a parcel of land as described below:

A parcel of land being part of Lot 6 of Baywood Estates Subdivision, located in the Northwest 1/4 of Section 1, Town 3 North, Range 16 East, Town of Sugar Creek, Walworth County, Wisconsin, described as follows: Begin at a found iron pipe marking the Southeast Corner of said Lot 6; thence S 62°46'16" W, along the South line of said Lot 6, 8.50 feet; thence N 24°39'00" W 238.89 feet to a found iron pipe on the East line of said Lot 6 and the meander line of Lauderdale Lake; thence S 26°41'20" E, along said East line, 131.16 feet; thence S 63°18'40" W 4.67 feet; thence S 34°44'37" E 33.33 feet to said East line of Lot 6; thence S 26°41'20" E, along said East line, 74.50 feet to the Point of Beginning. Said parcel contains 0.022 acres (937 sq.ft.) of land, more or less.

Meander line as shown on subdivision plat.
Meander line as shown on previous surveys.

Lot 7

House
Floor Elev.=897.7
Floor Elev.=900.7
Wood Deck
Conc.

Lot 6

Lot 5

House
Floor Elev.=898.8 Lower Level
Wood Deck
Steps
Conc.
Conc. Covers

Note: Proposed improvements are shown as instructed by the client. All setbacks must be approved by the Building Inspector prior to construction.

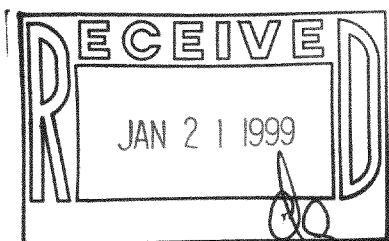

Surveyed for: **Thelen Total Construction, Inc.**
N5896 US Highway 12
Elkhorn, Wisconsin. 53121

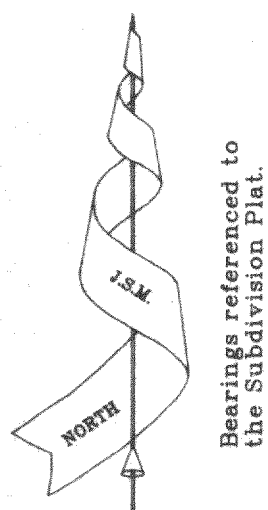

Bearings referenced to the Subdivision Plat.

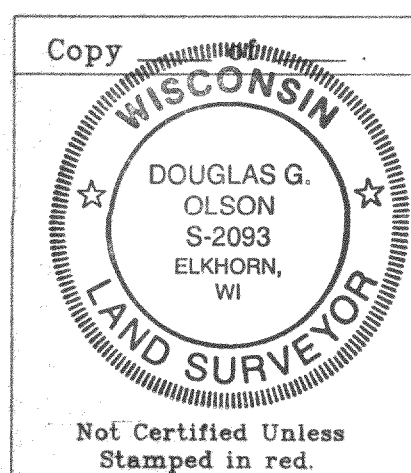

Note: This survey is subject to Wisconsin lien laws. This Plat of Survey is the notice of intent to file lien. Lien waiver required.

Note: This survey plat is not certified unless signed and sealed in red ink.

Copyright © 1998 by Jensen & Olson Land Surveying, LLC

All rights reserved. No part of this survey plat may be reproduced or transmitted in any form by any means - graphic, electronic, or mechanical, including photocopying, tracing, or information storage and retrieval systems - without permission in writing from Douglas G. Olson, Jensen & Olson Land Surveying, LLC.

I, Douglas G. Olson, Wisconsin Registered Land Surveyor, do hereby certify that this survey was performed by me, or under my direction in full compliance with the owner's / agent's instructions and Chapter A-E 7 of the Wisconsin Administrative Code "Minimum Standards for Property Surveys"; and that this map is as accurate representation thereof to the best of my knowledge and belief.

Date: 10-15-98

Douglas G. Olson R.L.S. 2093

Jensen & Olson Land Surveying, LLC

45 South Wisconsin Street P.O. Box 322
Elkhorn, Wisconsin. 53121
Telephone: (414) 723-3434
Facsimile: (414) 723-8044

Septic Vent

Mapping Date: 8-15-98

Revisions: 9-28-98

10-15-98

Sheet 2 of 2 Sheets

Job Reference No.

1998.064

Legend

- Found Iron Pipe
- Found Iron Rod
- Set Iron Rod
- () Recorded Information
- ✕ Utility Pole
- Blacktop Surface
- Wood Stake Set Oct 14, 1998.
- ☆ Soil Boring

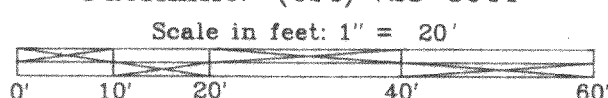

Mill Lake

Lake Elevation
884.82 on 8-20-98.

Plat of Survey

Lot 6 of Baywood Estates Subdivision, located in the Northwest 1/4 of Section 1, Town 3 North, Range 16 East, Town of Sugar Creek, Walworth County, Wisconsin,

Also part of Lot 5 of said Baywood Estates Subdivision as described below:

A parcel of land being part of Lot 5 of Baywood Estates Subdivision, located in the Northwest 1/4 of Section 1, Town 3 North, Range 16 East, Town of Sugar Creek, Walworth County, Wisconsin, described as follows: Commence at an iron pipe marking the Southwest Corner of said Lot 5; thence N 26°41'20" W, along the West line of said Lot 5, 238.66 feet to a found iron pipe on the meander line of Lauderdale Lake and the Point of Beginning; thence continue N 26°41'20" W, along said West line of Lot 5, ±79.5 feet to the shore of said Lauderdale Lake; thence northeasterly along said shore line ±2.8 feet; thence S 24°39'00" E ±79.5 feet to the Point of Beginning. Said parcel contains 0.003 acres (112 sq.ft.) of land, more or less.

Excepting from said Lot 6 a parcel of land as described below:

A parcel of land being part of Lot 6 of Baywood Estates Subdivision, located in the Northwest 1/4 of Section 1, Town 3 North, Range 16 East, Town of Sugar Creek, Walworth County, Wisconsin, described as follows: Begin at a found iron pipe marking the Southeast Corner of said Lot 6; thence S 62°46'16" W, along the South line of said Lot 6, 8.50 feet; thence N 24°39'00" W 238.89 feet to a found iron pipe on the East line of said Lot 6 and the meander line of Lauderdale Lake; thence S 26°41'20" E, along said East line, 131.16 feet; thence S 63°18'40" W 4.67 feet; thence S 34°44'37" E 33.33 feet to said East line of Lot 6; thence S 26°41'20" E, along said East line, 74.50 feet to the Point of Beginning. Said parcel contains 0.022 acres (937 sq.ft.) of land, more or less.

Note: Proposed improvements are shown as instructed by the client. All setbacks must be approved by the Building Inspector prior to construction.

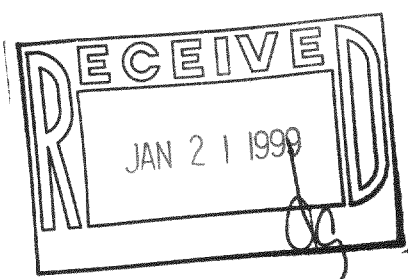

Surveyed for: **Thelen Total Construction, Inc.**
N5896 US Highway 12
Elkhorn, Wisconsin. 53121

Note: This survey is subject to Wisconsin lien laws. This Plat of Survey is the notice of intent to file lien. Lien waiver required.

Note: This survey plat is not certified unless signed and sealed in red ink.

Copyright © 1998 by Jensen & Olson Land Surveying, LLC

All rights reserved. No part of this survey plat may be reproduced or transmitted in any form by any means - graphic, electronic, or mechanical, including photocopying, tracing, or information storage and retrieval systems - without permission in writing from Douglas G. Olson, Jensen & Olson Land Surveying, LLC

I, Douglas G. Olson, Wisconsin Registered Land Surveyor, do hereby certify that this survey was performed by me, or under my direction in full compliance with the owner's/ agent's instructions and Chapter A-E 7 of the Wisconsin Administrative Code "Minimum Standards for Property Surveys", and that this map is as accurate representation thereof to the best of my knowledge and belief.

Date: 8-15-98

Douglas G. Olson R.L.S. 2003

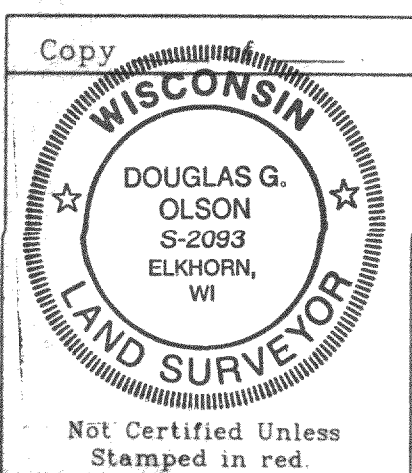

Jensen & Olson Land Surveying, LLC
45 South Wisconsin Street P.O. Box 322
Elkhorn, Wisconsin. 53121
Telephone: (414) 723-3434
Facsimile: (414) 723-8044

Scale in feet: 1" = 20'
0' 10' 20' 40' 60'

Septic Vent
Mapping Date: 8-15-98
Revisions:

Sheet 1 of 2 Sheets

Job Reference No.

1998.064

Legend

- Found Iron Pipe
- Found Iron Rod
- Set Iron Rod
- Recorded Information
- Deciduous Tree & Dia.
- Coniferous Tree & Dia. with Utility Pole
- Blacktop Surface

Mill Lake

Lake Elevation
884.82 on 8-20-98.

Plat of Survey

Lot 6 of Baywood Estates Subdivision, located in the Northwest 1/4 of Section 1, Town 3 North, Range 16 East, Town of Sugar Creek, Walworth County, Wisconsin,

Also part of Lot 5 of said Baywood Estates Subdivision as described below:

A parcel of land being part of Lot 5 of Baywood Estates Subdivision, located in the Northwest 1/4 of Section 1, Town 3 North, Range 16 East, Town of Sugar Creek, Walworth County, Wisconsin, described as follows: Commence at an iron pipe marking the Southwest Corner of said Lot 5; thence N 26° 41' 20" W, along the West line of said Lot 5, 238.66 feet to a found iron pipe on the meander line of Lauderdale Lake and the Point of Beginning; thence continue N 26° 41' 20" W, along said West line of Lot 5, +79.5 feet to the shore of said Lauderdale Lake; thence northeasterly along said shore line +2.8 feet; thence S 24° 39' 00" E +79.5 feet to the Point of Beginning. Said parcel contains 0.003 acres (112 sq.ft.) of land, more or less.

Excepting from said Lot 6 a parcel of land as described below:

A parcel of land being part of Lot 6 of Baywood Estates Subdivision, located in the Northwest 1/4 of Section 1, Town 3 North, Range 16 East, Town of Sugar Creek, Walworth County, Wisconsin, described as follows: Begin at a found iron pipe marking the Southeast Corner of said Lot 6; thence S 62° 46' 16" W, along the South line of said Lot 6, 8.50 feet; thence N 24° 39' 00" W 238.89 feet to a found iron pipe on the East line of said Lot 6 and the meander line of Lauderdale Lake; thence S 26° 41' 20" E, along said East line, 131.16 feet; thence S 63° 18' 40" W 4.67 feet; thence S 34° 44' 37" E 33.33 feet to said East line of Lot 6; thence S 26° 41' 20" E, along said East line, 74.50 feet to the Point of Beginning. Said parcel contains 0.022 acres (937 sq.ft.) of land, more or less.

Note: Proposed improvements are shown as instructed by the client. All setbacks must be approved by the Building Inspector prior to construction.

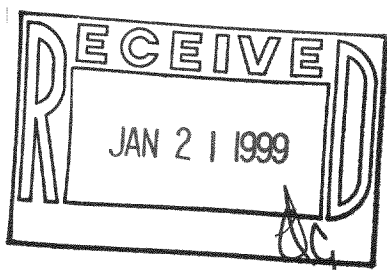

Surveyed for: **Thelen Total Construction, Inc.**
N5896 US Highway 12
Elkhorn, Wisconsin. 53121

Note: This survey is subject to Wisconsin lien laws. This Plat of Survey is the notice of intent to file lien. Lien waiver required.

Note: This survey plat is not certified unless signed and sealed in red ink.

Copyright © 1998 by Jensen & Olson Land Surveying, LLC

All rights reserved. No part of this survey plat may be reproduced or transmitted in any form by any means - graphic, electronic, or mechanical, including photocopying, tracing, or information storage and retrieval systems - without permission in writing from Douglas G. Olson, Jensen & Olson Land Surveying, LLC.

I, Douglas G. Olson, Wisconsin Registered Land Surveyor, do hereby certify that this survey was performed by me, or under my direction in full compliance with the owner's / agent's instructions and Chapter A-E 7 of the Wisconsin Administrative Code "Minimum Standards for Property Surveys", and that this map is as accurate representation thereof to the best of my knowledge and belief.

Date: 8-15-98

Douglas G. Olson R.L.S. 2093

Jensen & Olson Land Surveying, LLC
45 South Wisconsin Street P.O. Box 322
Elkhorn, Wisconsin. 53121
Telephone: (414) 723-3434
Facsimile: (414) 723-8044

Mapping Date: 8-15-98
Revisions:

Sheet 1 of 1 Sheets

Job Reference No.

1998.064

Legend

- Found Iron Pipe
- Found Iron Rod
- Set Iron Rod
- Recorded Information
- Deciduous Tree & Dia.
- Coniferous Tree & Dia. with
- Utility Pole ± drip line
- Blacktop Surface

Scale in feet: 1" = 20'

GBE-6A 316-1694